

Aeroprakt Ltd.

24, Polevaya str., Kiev, Ukraine

Tel: 0038 044 496-77-21

Fax: 0038 044 496-77-31

e-mail: aeroprakt.kiev@gmail.com

www.aeroprakt.kiev.ua

AEROPRAKT-32

Pilot Operating Handbook

A32-048-POH

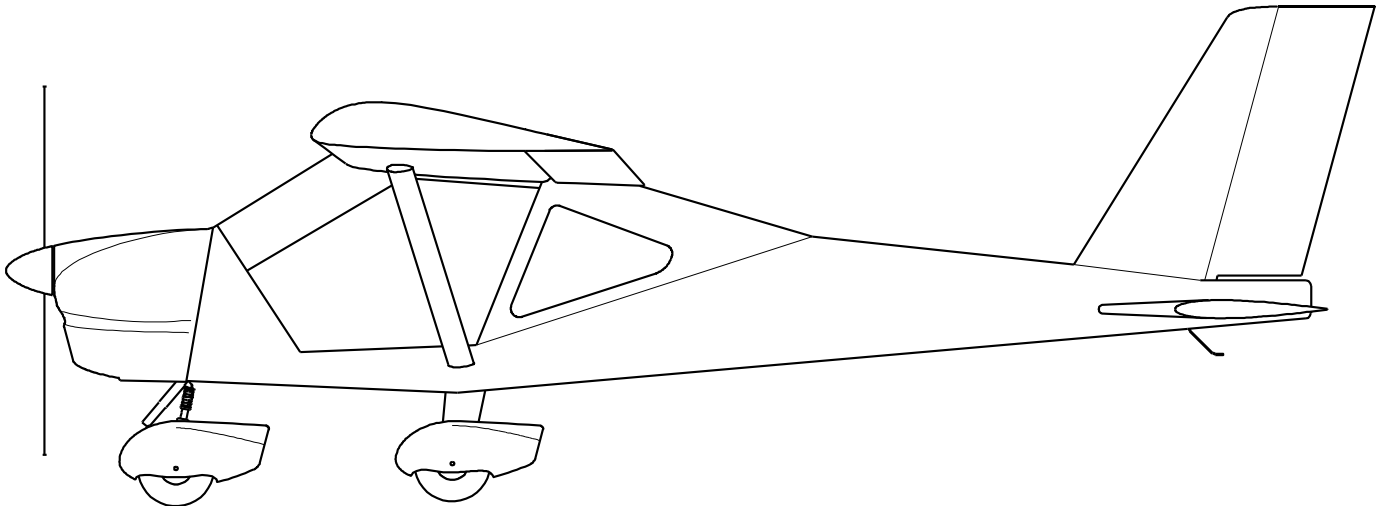

Airplane Model:	AEROPRAKT-32 (A-32)
Airplane Registration Number:	
Airplane Serial Number:	048
Date of issue:	12.01.2018
Approved by:	Yuriy Yakovlyev
Position:	Chief designer
Date of approval:	12.01.2018

This manual must be carried in the airplane at all times.

This airplane is to be operated in compliance with information and limitations contained herein.

RECORD OF MANUAL REVISIONS

No part of this manual may be reproduced or changed in any manner without a written consent of the Manufacturer.

Any revision of the present manual, except actual weighing data, must be recorded in the following table according to information from the Manufacturer.

New or amended text in the revised pages will be indicated by a black vertical line on the left hand margin, and the Revision No. and the date will be shown on the bottom left hand side of the page.

Rev. No.	Affected Section	Affected Pages	Date	Approval	Date	Date Inserted	Signature

Table of contents

Introduction	5
1 General information.....	6
1.1 General description of the airplane	6
1.2 Airplane specifications.....	6
2 Limitations.....	7
2.1 Airspeeds and Airspeed Indicator markings.....	7
2.2 Service ceiling	8
2.3 Maneuvering load factors	8
2.4 Approved maneuvers	8
2.5 Fuel capacity and type	8
2.6 Engine	9
2.7 Kinds of operation limits	9
2.8 Crosswind limitation	9
3 Emergency procedures.....	10
3.1 General.....	10
3.2 Emergency checklists.....	10
4 Normal Procedures.....	15
4.1 General.....	15
4.2 Preflight check.....	15
4.3 Engine starting	17
4.4 Taxiing.....	18
4.5 Before takeoff	18
4.6 Normal takeoff.....	18
4.7 Short/soft field takeoff.....	18
4.8 Climb	19
4.9 Cruise	19
4.10 Approach	19
4.11 Normal landing	19
4.12 Short/soft field landing.....	20
4.13 Balked landing.....	20
5 Performance.....	21
5.1 General.....	21
5.2 Takeoff and landing distances.....	21
5.3 Climb performance	21
5.4 Cruise speeds and fuel consumption at various RPM settings	21
6 Weight and Balance and Equipment List	22
6.1 Weight and Balance Chart	22
6.2 Installed equipment list.....	23

7 Airplane and Systems Descriptions	25
7.1 General.....	25
7.2 Airframe.....	25
7.3 Landing gear	25
7.4 Engine and its controls	26
7.5 Propeller	26
7.6 Fuel system	27
7.7 Airplane control systems	29
7.8 Instrument panel.....	38
7.9 Full and static pressure system.....	40
7.10 Electrical system	41
7.11 Seats and harness belts.....	46
7.12 Cockpit doors	46
7.13 Baggage compartment.....	46
7.14 Recovery system.....	46
8 Aircraft Ground Handling and Servicing	48
8.1 Introduction.....	48
8.2 Towing, parking and tie-down instructions	48
8.3 Servicing fuel, oil and coolant.....	48
8.4 Approved fuel and oil.....	49
8.5 Cleaning and care	49
8.6 Disassembling and assembling the airplane	49
9 Supplements	53
9.1 General.....	53
9.2 Engine manual	53
9.3 Avionics and special engine instruments	53
9.4 Recovery system.....	53
9.5 Floats.....	53
9.6 List of installed equipment.....	54
9.7 Actual empty weight and CG position data	55
9.8 Airplane Flight Training Supplement	56
9.9 Airplane Owner Feedback to Manufacturer.....	59

Introduction

This Pilot Operating Handbook has been prepared to provide the airplane owner and operators with information required for the safe and efficient operation of this airplane.

The following ASTM standards have been and/or shall be used for the design, construction and continued airworthiness of this Aeroprakt-32 (A-32) airplane:

- F2245-16 Standard Specification for Design and Performance of a Light Sport Airplane,
- F2295-10 Standard Practice for Continued Operational Safety Monitoring of a Light Sport Aircraft,
- F2316-12 Standard Specification for Airframe Emergency Parachutes for Light Sport Aircraft,
- F2339-06 Standard Practice for Design and Manufacture of Reciprocating Spark Ignition Engines for Light Sport Aircraft,
- F2506-13 Standard Specification for Design and Testing of Light Sport Aircraft Propellers,
- F2745-15 Standard Specification for Required Product Information to be Provided with an Airplane
- F2746-14 Standard Specification for Pilot's Operating Handbook (POH) for Light Sport Airplane,
- F2972-15 Standard Specification for Light Sport Aircraft Manufacturer's Quality Assurance System.

This A-32 airplane was manufactured by:

Aeroprakt Ltd.
24 Polyova str.
Kyiv, 03056
UKRAINE
Tel.: +380 44 496-77-21
Fax: +380 44 496-77-31
E-mail: aeroprakt.kiev@gmail.com
www.aeroprakt.kiev.ua

Should the original manufacturer of the aircraft lose its ability to support this aircraft make and model, contact:

Peter Harlow
Foxbat Australia
8 A Regent Street
Brighton East
Victoria 3187
Australia
Tel/fax - +61 (0) 3 9592 3101
Mobile/cell - +61 (0) 413 900 892

1 General information

1.1 General description of the airplane

AEROPRAKT-32 (A-32) is a two-seat, high-wing strut braced monoplane of "classic" aerodynamic layout with closed cockpit, non-retractable landing gear with steerable nose wheel, Rotax-912 engine with tractor three-blade on-ground adjustable pitch propeller.

AEROPRAKT-32 is approved for flying in VFR, simple meteorological conditions.

AEROPRAKT-32 is certified in the LSA (Light Sport Airplane) category.

1.2 Airplane specifications

Specification	US units	Metric
Wing span	31 ft	9.45 m
Wing area	138 sq ft	12.83 m ²
Length	20 ft 7 in	6.27 m
Height	7 ft 3 in	2.22 m
Wheel base	4 ft 2 in	1.27 m
Wheel track	5 ft 9 in	1.75 m
Gross weight (Maximum Take-Off Weight, MTOW)	1320 lb	600 kg
Top speed at sea level, ISA conditions	116 kts	215 km/h
Cruising speed (IAS) at 1000 ft, ISA conditions, engine RPM:		
	3500	54 kts 100 km/h
	3800	67 kts 125 km/h
	4200	81 kts 150 km/h
	4650	94 kts 175 km/h
	5150	108 kts 200 km/h
	5500	116 kts 215 km/h
Range with full tanks (30 min. reserve) at 1000 ft, still air, ISA conditions, 3700 RPM	706 nm	1307 km
Best angle of climb speed (V_X), IAS	54 kts	100 km/h
Best rate of climb speed (V_Y), IAS	65 kts	120 km/h
Stalling speed at MTOW, flaps up (V_S), IAS	32 kts	60 km/h
Stalling speed at MTOW, full flaps (V_{S0}), IAS	27 kts	50 km/h
Maximum engine power at 5800 RPM (5 minutes limit)	100 hp	73.5 kW
Total fuel capacity	23.8 US gal	90 l
Usable fuel	23.6 US gal	89.5 l
Approved fuel types: unleaded mogas min. RON 95 or avgas 100LL		

2 Limitations

2.1 Airspeeds and Airspeed Indicator markings

Airspeed limitations and corresponding IAS values are given in the table below.

Scheme of color markings of airspeed indicator is shown on **Fig. 1**. Its explanation is given in the table below.

Marking	IAS value or range, km/h (kts)	Airspeed (range) symbol(s) and description
White arc start	50 (27)	V_{S0} – stalling speed at maximum takeoff weight with full flaps
Green arc start	60 (32)	V_S – stalling speed at maximum takeoff weight with flaps up
White arc	50 - 147 (27 - 79)	V_{S0} to V_{FE} – flap extended speed range
Green arc	60 - 151 (32 - 81)	V_S to V_O – normal operating speed range
Green and Yellow arcs border	151 (81)	V_O – operating maneuvering speed at gross weight and minimum weight
Yellow arc	151 - 240 (81 - 130)	V_O to V_{NE} – in this range maneuvers must be conducted with caution and only in smooth air
Red line	240 (130)	V_{NE} – never-exceed speed, maximum speed for all operations

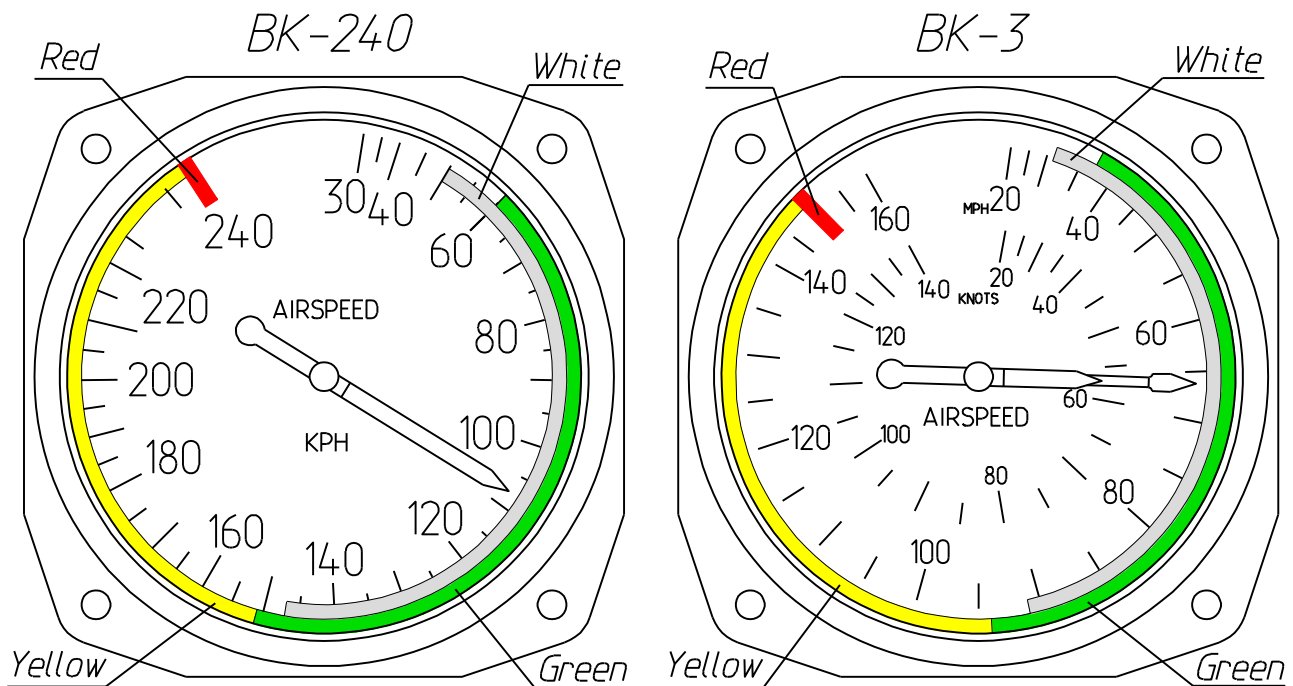

Fig. 1. Airspeed Indicator markings

2.2 Service ceiling

Service ceiling of A-32 with Rotax-912ULS (100 hp) engine is equal to at least 5000 m (16 000 ft).

However A-32 has neither pressurized cockpit nor oxygen equipment and therefore may not be used for high-altitude flight.

2.3 Maneuvering load factors

Limit load factors for the airplane at gross weight of 600 kg (1320 lb) are as follows:

Maximum positive limit load factor +4.0

Maximum negative limit load factor -2.0

2.4 Approved maneuvers

A-32 airplane belongs to a non-aerobatic category. All maneuvers shall be done within its airspeed and maneuvering load factor limits (G limits). Approved maneuvers include:

- turns with bank angles up to 60°,
- side-slipping with angles up to 15°,
- level and accelerated stalls without spinning,
- diving at a speed below V_{NE} of 240 km/h (130 kts) IAS.

Any aerobatics including intentional spinning is prohibited!

2.5 Fuel capacity and type

	Standard	Optional
Capacity of tanks:	2×45 l (11.9 US gal)	2×57 l (2×15.05 US gal)
Total fuel capacity:	90 l (23.8 US gal)	114 l (30.1 US gal)
Total usable fuel:	89.5 l (23.6 US gal)	113.5 l (30.0 US gal)
Non-usable fuel:	0.5 l (0.13 US gal)	0.5 l (0.13 US gal)

Approved fuel types: see table in paragraph **2.6 Engine**.

NOTE: The readings of the fuel level indicators have to be read as follows (for both standard and optional fuel tanks):

«4/4» — 38 l (10.57 US gal);

«1/2» — 21 l (5.55 US gal);

«0» — 10 l (2.64 US gal);

«reserve fuel remains» light ignites — 8 l (2.11 US gal).

2.6 Engine

Engine data and operational limitations are given in the table below:

Engine manufacturer:	BRP-Rotax GmbH&Co KG, Austria	
Engine model:	Rotax-912ULS	
Maximum takeoff power:	100 h.p.	
Time limit at full power:	5 min (5800 rpm)	
Max. revolutions (no time limit)	5500 rpm	
Min. revolutions at idle	1400 rpm	
Coolant temperature limit measured in cylinder head:	120°C (248°F)	
Oil temperature, normal	90-110°C (190-230°F)	
minimum	50°C (122°F)	
maximum	130°C (266°F)	
Exhaust gas temperature, max	880°C (1616°F)	
Oil pressure, normal	2.0-5.0 bar (29-73 psi) (above 3500 RPM)	
minimum	0.8 bar (12 psi) (below 3500 RPM)	
maximum	7 bar (100 psi) (at cold start, allowed for a short time)	
Fuel pressure, normal	0.15-0.4 bar (2.2-5.8 psi)	
maximum	0.5 bar (7.26 psi)	
Fuel:	antiknock properties	min. RON 95 (min. AKI 91 ¹)
	European standard	EN 228 super, EN 228 super plus
	Aviation standard	AVGAS 100 LL (ASTM D910)
Oil:	with RON 424 classification	
Ambient air temperature range	from -25°C (-13°F) to +50°C (+122°F)	

NOTE: On all issues of engine operation see Rotax engine Operator's Manual. Follow its instructions to ensure safe and efficient operation of the engine.

2.7 Kinds of operation limits

This aircraft is approved for flying day and night, VFR, simple meteorological conditions. Flight into icing conditions is prohibited.

2.8 Crosswind limitation

Maximum crosswind component for A-32 airplane is 7 m/s (14 kts).

It is highly recommended to choose upwind direction for takeoff and landing with the least crosswind. It will significantly shorten takeoff and landing distances and increase degree of safety.

¹ Anti Knock Index (RON+MON)/2

3 Emergency procedures

3.1 General

This section contains recommendations to the pilots in case of emergency in flight. However such situations, caused by airframe or engine malfunction are extremely rare provided that pre-flight inspections and checks are performed regularly.

3.2 Emergency checklists

3.2.1 Engine fire during start

1. Throttle – IDLE
2. Ignition – OFF.
3. Fuel valves – CLOSE.
4. Unfasten seat belts, abandon cockpit.
5. Take measures to extinguish the fire.

3.2.2 Engine failure during takeoff

3.2.2.1 during takeoff roll

1. Throttle – IDLE.
2. Ignition – OFF.
3. Brakes – APPLY as necessary.

3.2.2.2 immediately after takeoff

1. Direction – NO TURN BACK.
2. Airspeed – 110 km/h (59 kts) – best glide.
3. Throttle – IDLE.
4. Ignition – OFF.
5. Master switch – OFF.
6. Fuel valves – CLOSE.
7. Landing – STRAIGHT AHEAD, avoid colliding with obstacles.

3.2.3 Loss of engine power in flight

3.2.3.1 during climb

1. Airspeed – 110 km/h (59 kts) – best glide.
2. Throttle – IDLE.
3. Ignition – OFF.
4. Fuel valves – CLOSE.
5. Direction – TURN to the airfield (if altitude permits).
6. Landing – STRAIGHT AHEAD, avoid colliding with obstacles.

3.2.3.2 in level flight

1. Airspeed – 110 km/h (59 kts) – best glide.
2. Landing area – SELECT (consider altitude and wind).
3. Engine – RESTART (if time and altitude permit), see section 3.2.4.
4. Unable to restart – follow emergency landing procedure, see section **3.2.5**.

3.2.4 Restarting engine in flight

1. Throttle – IDLE.
2. Fuel valves – check OPEN.
3. Fuel level – CHECK.
4. Ignition – ON.
5. Master key – turn to START.

3.2.5 Emergency landing without engine power

1. Airspeed – 110 km/h (59 kts) – best glide.
2. Flaps – position 1.
3. Ignition – OFF.
4. Fuel valves – CLOSE.
5. Landing area – SELECT, consider altitude and wind. (No place suitable for landing – use recovery system.)
6. Emergency call – TRANSMIT (121.5 MHz or nearest airfield frequency).
7. Flaps – EXTEND FULLY on final.
8. Landing – in the SELECTED place, avoid colliding with obstacles.
9. Touchdown – at minimum speed.

3.2.6 Precautionary landing with engine power

(In case of decision to discontinue the flight with engine running)

1. Airspeed – SELECT SAFE for the particular situation.
2. Throttle – SET to maintain selected airspeed.
3. Fuel – CHECK level and valves.
4. Map – CHECK for nearest airfields/area suitable for landing.
5. Landing area – SELECT.
6. Radio – REPORT decision to land on the selected place if necessary.
7. Landing – follow NORMAL or SHORT-FIELD landing procedure as appropriate.

3.2.7 Fire in flight

1. Ignition – OFF.
2. Fuel valves – CLOSE.
3. Yoke – PUSH to descend.
4. Airspeed – BELOW 240 km/h (130 kts).
5. Landing area – SELECT (consider altitude and wind).
6. Landing – in the SELECTED place, avoid colliding with obstacles.
7. Unfasten seat belts, abandon cockpit.
8. Take measures to extinguish the fire.

3.2.8 Loss of oil pressure

1. Follow PRECAUTIONARY LANDING procedure, see section 3.2.6.
2. Engine overheating or stopped – follow EMERGENCY LANDING procedure, see section 3.2.5.

3.2.9 High oil pressure

1. Throttle – REDUCE rpm, IDLE if necessary.
2. Airspeed – 110 km/h (59 kts) – best glide.
3. Oil pressure – CONTROL.
4. Oil pressure normal – follow PRECAUTIONARY LANDING procedure, see section 3.2.6.
5. Oil pressure high – follow EMERGENCY LANDING procedure, see section 3.2.5.

3.2.10 Emergency descent

1. Yoke – PUSH to descend.
2. Throttle – IDLE.
3. Airspeed – BELOW 240 km/h (130 kts).
4. Engine speed – BELOW 5800 rpm.
5. Air traffic – CONTROL to avoid collisions.
6. Altitude – CONTROL.
7. Terrain – CONTROL.
8. At safe altitude – PULL YOKE GENTLY to level off.
9. G loads – DO NOT EXCEED +4g.

3.2.11 Alternator failure

Follow PRECAUTIONARY LANDING procedure, see section 3.2.6.

3.2.12 Overvoltage

1. Additional electrical consumers (landing light, strobes, etc.) – switch ON.
2. Voltage – CHECK.
3. Voltage normal – CONTINUE normal flight.
4. Voltage high – REMOVE battery charge fuse and FOLLOW PRECAUTIONARY LANDING procedure, see section 3.2.6.

3.2.13 Inadvertent spin

1. Rudder pedals – FULLY AGAINST ROTATION.
2. Yoke – PUSH to stops.
3. Rotation stopped – rudder pedals NEUTRAL.
4. Speed reached 110 km/h (59 kts) – PULL YOKE GENTLY to recover from diving.
Do not exceed +4g and 240 km/h (130 kts)!

WARNING: Intentional spinning in A-32 is prohibited!

NOTE: In level flight and during turn stall warning is assured by the aerodynamic characteristics of A-32 – gentle shaking of the airplane and yoke due to the starting airflow separation.

3.2.14 Inadvertent icing encounter

1. Abandon icing build-up area.
2. Icing build-up not stopped – FOLLOW PRECAUTIONARY LANDING procedure, see section 3.2.6.

3.2.15 Loss of primary instruments

3.2.15.1 ASI failure due to full pressure line blockage

Signs of the blockage – airspeed indicator reading either:

- does not change with changing airspeed in level flight or,
- reduces during a steady descent or,
- increases during a steady climb.

1. Airspeed indicator readings – IGNORE.
2. In level flight – SET THROTTLE to 4000-4500 rpm.
3. Altitude – MAINTAIN.
4. In descent – SET THROTTLE to IDLE.
5. Sink rate – SET to 3 m/s (600 ft/min).
6. Follow PRECAUTIONARY LANDING procedure, see section 3.2.6.

3.2.15.2 Altimeter, VSI and ASI failure due to static pressure line blockage

Signs of the blockage:

- altimeter and vertical speed indicator readings do not change with changing altitude or,
- airspeed indicator reading increases during a steady descent or,
- airspeed indicator reading reduces during a steady climb.

1. IGNORE altimeter, VSI and ASI readings.
2. Airplane attitude – CONTROL by the position of the horizon line with relation to the wings and engine cowling.
3. Airspeed and vertical speed – CONTROL using throttle.
4. Follow PRECAUTIONARY LANDING procedure, see section 3.2.6.

3.2.15.3 Powerplant instruments failure

(Tachometer, oil, water and exhaust temperature indicators, fuel quantity indicator)

1. IGNORE powerplant instruments readings.
2. Engine rpm – CONTROL by engine noise.
3. Follow PRECAUTIONARY LANDING procedure, see section **3.2.6**.

3.2.16 Loss of flight controls

1. Elevator control fails – use elevator TRIM TAB control.
2. Rudder control fails – use AILERONS to control direction.
3. Aileron control fails – use RUDDER to control bank.

4 Normal Procedures

4.1 General

This section describes normal procedures recommended for safe operation of the A-32.

4.2 Preflight check

Pilots must inspect the general condition of the airplane during its preflight check. The airplane must have no damage or maladjustments that may be critical for the flight safety. The cockpit glass, propeller, wing and empennage must be clean of rainwater, snow, frost, ice, and dirt as they impair visibility and aerodynamics and increase weight.

Preflight check must be performed according to the following order and requirements:

4.2.1 Entire airplane

1. Covers and clamps – REMOVED.
2. Airplane – CLEAN of rainwater, snow, frost, ice and dirt.
3. Rigging – CHECK visually.
4. External damage – NONE.

4.2.2 Power plant

1. Propeller and spinner – CLEAN, INTACT and SECURE.
2. Top cowling – REMOVE for engine inspection.
3. Oil, coolant and braking fluid – CHECK level.
4. Engine mount and vibration dampers – NO CRACKS and INTACT.
5. Cables and hoses – INTACT and SECURE.
6. Fuel, oil, coolant leaks – NONE.
7. Exhaust system, its attachments, joints and springs – NO CRACKS and INTACT.
8. Top cowling – INSTALL back.
9. Cowling and its locks – INTACT and LOCKED.

4.2.3 Landing gear

1. Wheel fairings – CLEAN, INTACT and SECURE.
2. Wheel pressure – OK.
3. Tires – NO CRACKS, WEAR OK.
4. Main wheel brakes – CLEAN, INTACT and SECURE.
5. Braking fluid – NO LEAKS.
6. Nose and main legs – NO CRACK and INTACT.
7. Nose leg shock absorber – INTACT.

4.2.4 Right wing

1. Wing and strut surface – CLEAN and INTACT.
2. Wing and strut attachment fittings and bolts – IN PLACE, INTACT and SECURE.

3. Wing fuel tank cap – IN PLACE and SECURE.
4. Fuel leaks – NONE.
5. Fuel tank vent outlet – CLEAN and INTACT.
6. Wing tip and navigation/strobe light – INTACT.
7. Flaperon clamp – REMOVED.
8. Flaperon – CLEAN and INTACT.
9. Flaperon hinge brackets – INTACT, BOLTS SECURE, HINGES GREASED.
10. Flaperon control linkage attachment – INTACT and SECURE.

4.2.5 Right side of fuselage

1. Fuselage surface – CLEAN and INTACT.
2. Cockpit glass – CLEAN, INTACT and NO CRACKS.
3. Door hinges and lock – INTACT.
4. Recovery system condition – CHECK visually.
5. Drain valve – CLOSED, NO FUEL LEAKS.
6. Fuel residue – DRAIN and CHECK.

4.2.6 Empennage

1. Empennage surface – CLEAN and INTACT.
2. Clamps/stops – REMOVED.
3. Horizontal stabilizer attachment fittings and bolts – INTACT and SECURE.
4. Rudder, elevator and trim tab – CLEAN and INTACT.
5. Rudder, elevator and trim tab hinge brackets – INTACT, SECURE and GREASED.
6. Rudder, elevator and trim tab control linkage attachment – INTACT and SECURE.

4.2.7 Left side of fuselage

1. Fuselage surface – CLEAN and INTACT.
2. Cockpit glass – CLEAN, INTACT and NO CRACKS.
3. Door hinges and lock – INTACT.
4. Battery and power cables' attachment – SECURE, CONDITION OK.
5. Control system linkages inside the rear fuselage – CHECK visually.
6. Baggage container condition – CHECK visually.

4.2.8 Left wing

1. Flaperon control linkage attachment – INTACT and SECURE.
2. Flaperon hinge brackets – INTACT, BOLTS SECURE, HINGES GREASED.
3. Flaperon – CLEAN and INTACT.
4. Flaperon clamp – REMOVED.
5. Fuel tank vent outlet – CLEAN and INTACT.

6. Fuel leaks – NONE.
7. Wing fuel tank cap – IN PLACE and SECURE.
8. Wing tip and navigation/strobe light – INTACT.
9. Wing and strut attachment fittings and bolts – IN PLACE, INTACT and SECURE.
10. Wing and strut surface – CLEAN and INTACT.
11. Pitot/static pressure probe – COVER REMOVED, CLEAN and INTACT.

4.2.9 Cockpit

1. Cockpit interior – CLEAN, INTACT, NO FOREIGN OBJECTS.
2. Seats – INTACT, ADJUSTED and SECURE.
3. Harness belts – INTACT, ADJUSTED and LOCKED (with pilots in the seats).
4. Doors – CLOSED and LOCKED.
5. Flight planning including weight and CG check – PERFORMED.
6. Onboard documentation/maps required for the flight – AVAILABLE.
7. Baggage container – BAGGAGE SECURED, CONTAINER CLOSED.
8. Starter key – REMOVED
9. All electrical switches – OFF.
10. Flight instruments – INTACT, CHECK READINGS.
11. Movements of controls – check FREE and FULL.
12. Yokes, rudder pedals, elevator trim tab lever – NEUTRAL.
13. Flaps – RETRACTED.
14. Parking brake – ON.

4.3 Engine starting

1. Starter key – INSERT, set to ON.
2. Fuel level – CHECK.
3. Fuel valves – CHECK.
4. Throttle – IDLE.
5. Doors – check CLOSED.
6. Choke lever (**cold engine only**) – set FULLY FORWARD.
7. Propeller – CHECK CLEAR.
8. Starter key (**cold engine only**) – set to START for 5 seconds with ignition OFF.
9. Ignition – ON.
10. Starter key – set to START until engine starts (10 seconds maximum).
11. Throttle – set MINIMUM STABLE REVOLUTIONS (approx. 1600-1700 RPM).
12. Choke lever – FULLY BACK (gradually, when engine runs smoothly).
13. Carburetor heating – OFF.
14. Engine – WARM UP at 2000-2500 RPM.

15. Required electric equipment/instruments – switch ON and ADJUST.
16. Ignition – TEST at 4000 RPM holding brakes.
17. Oil pressure – check 2.0-5.0 bar (29-73 psi) at above 3500 RPM.

4.4 Taxiing

1. Throttle – IDLE.
2. Parking brake – OFF.
 1. Coolant and oil temperature – CHECK.
3. Taxiway – CHECK CLEAR.
4. Throttle – SET REQUIRED TAXI SPEED.
5. Yoke – elevator NEUTRAL, ailerons AGAINST crosswind.
6. Brakes – use as required, set throttle to IDLE when stopping.
7. To stop immediately – IGNITION OFF and ENGAGE BRAKES.

4.5 Before takeoff

1. Hold position – OCCUPY.
2. Brakes – ENGAGE.
3. Coolant temperature – CHECK minimum 140°F (60°C).
4. Oil temperature – CHECK minimum 120°F (50°C).
5. Fuel level – CHECK.
6. Fuel valves – CHECK.
7. Flaps – EXTEND position 1.

4.6 Normal takeoff

1. Hold position – OCCUPY.
2. Rudder pedals – NEUTRAL.
3. Brakes – RELEASE.
4. Throttle – gradually FULL POWER.
5. Yoke – elevator NEUTRAL, ailerons AGAINST CROSSWIND.
6. Rudder pedals – maintain takeoff direction.
7. Yoke – PULL gently to lift the nose wheel at 40 km/h.
8. Liftoff – at 80 km/h.
9. Accelerate to at least 100 km/h (54 kts) at 3-7 ft and start to climb.

4.7 Short/soft field takeoff

1. Flaps – EXTEND FULLY.
2. Hold position – OCCUPY.
3. Takeoff distance – CHECK if sufficient.
4. Rudder pedals – NEUTRAL.

5. Throttle – gradually FULL POWER.
6. Brakes – RELEASE.
7. Yoke – elevator NEUTRAL, ailerons AGAINST CROSSWIND.
8. Rudder pedals – maintain takeoff direction.
9. Yoke – PULL gently to lift the nose wheel at 40 km/h.
10. Liftoff – at 65 km/h (35 kts).
11. Accelerate to at least 90 km/h (49 kts) at 1-2 m (3-7 ft) and start to climb.
12. Speed – SET best angle of climb speed $V_X = 100$ km/h (54 kts).

4.8 Climb

1. Speed – SET: best angle of climb speed $V_X = 100$ km/h (54 kts) or best rate of climb speed $V_Y = 120$ km/h (65 kts) in strong turbulence +10 km/h (5 kts).
2. Flaps – RETRACT SLOWLY at safe altitude.
3. EGT – max. 880°C (1560°F).
4. Coolant temperature – max. 120°C (248°F).
5. Oil pressure – max. 5.0 bar (73 psi).
6. Oil temperature – max. 130°C (266°F)

4.9 Cruise

1. Flight altitude – OCCUPY and monitor, in strong turbulence – at least 100 m (300 ft).
2. Cruise speed – SET, in strong turbulence – min. 100 km/h (54 kts), max. 151 km/h (81 kts).
3. Elevator trim tab – ADJUST as required.
4. Fuel level – MONITOR.
5. Fuel valves – check OPEN for fuel tank with fuel, CLOSE empty fuel tank.
6. Turns – perform with caution in strong turbulence and at low altitudes.

4.10 Approach

1. Speed – REDUCE below 147 km/h (79 kts), minimum 100 km/h (54 kts).
2. Flaps – EXTEND position 1. Wind stronger 8 m/s (16 kts) – FLAPS UP.
3. Elevator trim tab – ADJUST as required.
4. Approach speed on final – 100 km/h (54 kts), +10 km/h (5 kts) in rain or strong turbulence.
5. Too high on final – REDUCE RPM, at idle – SLIP.
6. Too low on final – INCREASE RPM. **DO NOT RETRACT FLAPS when flying low over high obstacles or close to the ground!**

4.11 Normal landing

1. Direction – ALIGN the airplane WITH THE RUNWAY using rudder pedals.

2. Side drift – ELIMINATE by banking against the drift (crosswind, if any).
3. Flare – start at 3 m (15 ft), level off at approximately 0.3 m (1 ft).
Gradually reduce bank and side drift while flaring and leveling off.
4. Throttle – IDLE.
5. Touchdown – at minimum speed. **Avoid touching ground with the tail.**
6. Yoke – HOLD to reduce the speed and PUSH gently to lower the nose wheel slowly.
7. Flaps – RETRACT.
8. Brakes – ENGAGE as required. **Avoid braking at a high speed or nose wheel up!**

4.12 Short/soft field landing

1. Flaps – EXTEND FULLY.
2. Approach distance – REDUCE by side slipping when clear of obstacles.
3. Approach speed on final – 90 km/h (49 kts), +10 km/h (5 kts) in rain or strong turbulence.
4. Direction – ALIGN the airplane WITH THE RUNWAY using rudder pedals.
5. Side drift – ELIMINATE by banking against the drift (crosswind, if any).
6. Flare – start at 3 m (15 ft), level off at approximately 0.3 m (1 ft).
Gradually reduce bank and side drift while flaring and leveling off.
7. Throttle – IDLE.
8. Touchdown – at minimum speed at the beginning of the runway. **Avoid touching ground with the tail.**
9. Flaps – RETRACT.
10. Yoke – HOLD to reduce the speed and PUSH gently to lower the nose wheel slowly.
11. Brakes – soft field: DO NOT USE;
short field – ENGAGE as required. **Avoid braking at a high speed or nose wheel up!**

4.13 Balked landing

1. Throttle – gradually FULL POWER.
2. Descent – DISCONTINUE.
3. Speed – accelerate to at least 100 km/h (54 kts) flying level.
4. Climb – at 100 km/h (54 kts).
5. Flaps – RETRACT SLOWLY at safe altitude.

5 Performance

5.1 General

This section contains performance data of A-32 airplane of standard (basic) configuration at maximum takeoff weight in the following environmental conditions: ICAO standard atmosphere (ISA), mean sea level (MSL), no wind, hard and even runway. Those data may vary depending upon the configuration and technical condition of a particular aircraft and actual environmental conditions of its operation.

5.2 Takeoff and landing distances

The minimum takeoff and landing distances of A-32 for the above conditions are specified below. However pilots should always keep in mind that actual takeoff and landing distances depend on condition of the aircraft, environment and pilot skill.

Takeoff/Landing run 100 m (328 ft)

Takeoff distance to 15 m (50 ft) 230 m (750 ft)

Landing distance from 15 m (50 ft) 244 m (800 ft)

5.3 Climb performance

The rate of climb depends on atmospheric conditions, airplane takeoff weight and flap setting. The climb performance data of A-32 in ISA conditions at MSL, maximum takeoff weight are specified below:

Best angle of climb speed V_X 100 km/h (54 kts)

Best rate of climb speed V_Y 120 km/h (65 kts)

Maximum rate of climb at V_X 5.5 m/s (1080 fpm)

Maximum rate of climb at V_Y 6 m/s (1180 fpm)

5.4 Cruise speeds and fuel consumption at various RPM settings

The cruise speeds and fuel consumption depend upon a multitude of factors: propeller pitch and engine adjustments, fuel quality, atmospheric conditions, flight altitude, aircraft loading and condition of its outer surface, etc.

With the KievProp three-blade propeller adjusted to take-off RPM of 5100 per minute and standard condition of atmosphere and aircraft the following cruise speeds and fuel consumption values may be used for flight planning:

Engine RPM	Cruise speed (IAS)		Fuel consumption	
3400	80 km/h	43 kts	6.9 l/h	1.83 US gal/h
3500	100 km/h	54 kts	7.2 l/h	1.90 US gal/h
3800	125 km/h	67 kts	8.5 l/h	2.24 US gal/h
4200	150 km/h	81 kts	10.5 l/h	2.78 US gal/h
4650	175 km/h	94 kts	13.0 l/h	3.43 US gal/h
5150	200 km/h	108 kts	16.9 l/h	4.47 US gal/h
5500	215 km/h	116 kts	21.5 l/h	5.69 US gal/h

However these values should be considered as approximate as they may vary due to effect of the above mentioned factors. It is recommended to verify those values for the particular conditions in which the exact values are required.

6 Weight and Balance and Equipment List

This section contains information about weight and balance requirements for the safe operation of the airplane. It is responsibility of the pilot in command to ensure before every flight that weight and balance of the airplane remains within the specified limits. Failure to do so may cause deterioration in airplane's flight performance and stability characteristics and, as consequence, lead to unsafe operation.

6.1 Weight and Balance Chart

This subsection contains weighing and CG location data of the aircraft in configuration “as built”. Any permanent modification of the aircraft configuration (such as replacement, removal/installation of any parts or/and equipment) essentially affecting those data shall be accounted for in this weight and balance chart by appropriate revisions of this subsection data.

Weight readings at: front wheel 61.5 kg
left wheel 134.6 kg
right wheel 130.0 kg

Total empty weight: 324.2 kg.

Total maximum take-off weight....600 kg.

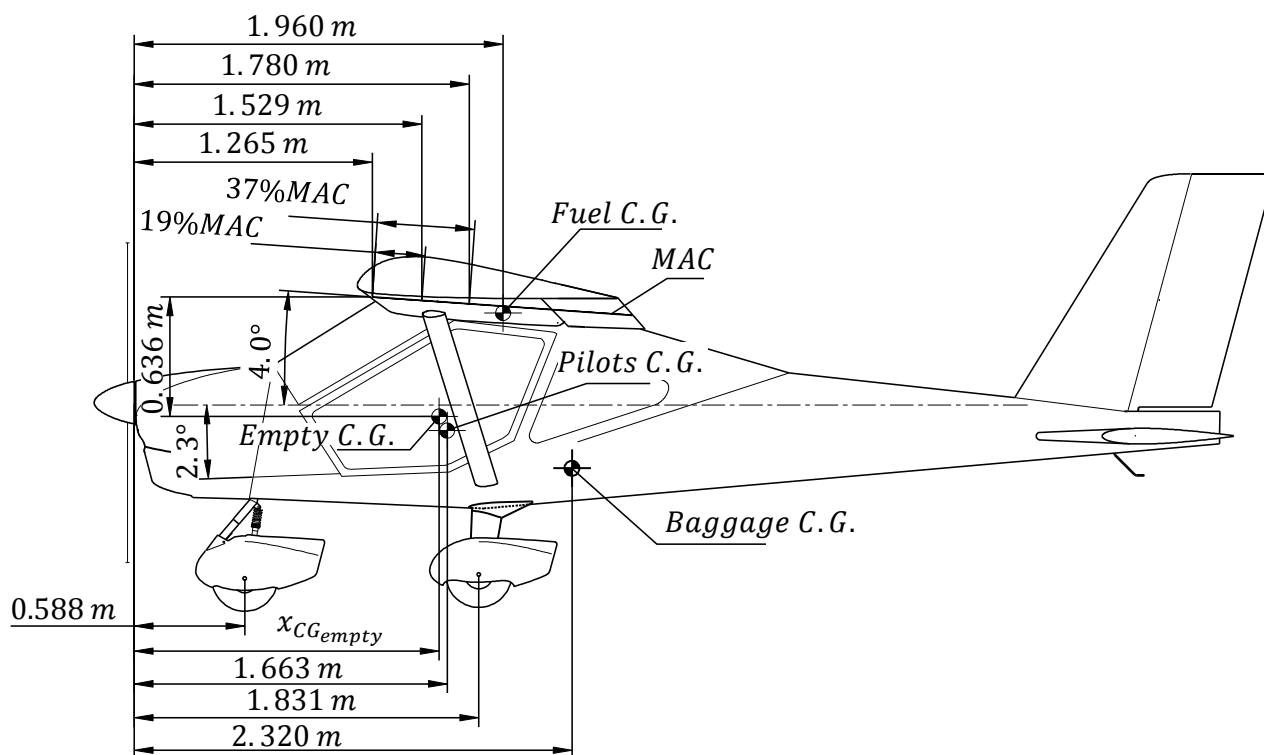

Fig. 2

Empty C.G. position from the datum (engine flange):

$$x_{CG_{empty}} = \frac{(61.5 \times 0.588 + (134.6 + 130.0) \times 1.831)}{61.5 + 134.6 + 130.0} = 1.595 \text{ m.}$$

C.G. position for the maximum take-off weight:

Item	Weight, kg/lbs	×	CG arm, m/inch	=	Moment, kg×m/lbs×inch
Empty airplane	324.2/714.9	×	1.595/62.8	=	517.2/44 896
Crew (2×90.0 kg)	180.0/396.9	×	1.663/65.5	=	299.3/25 986
Baggage	30.0/66.2	×	2.320/91.3	=	69.6/6 042
Fuel (2×45 l)	64.8/142.9	×	1.960/77.2	=	127.0/11 026
Total:	599.0/1 320.8				1013.1/87 949
$X_{CG} = \text{Total moment} / \text{Total weight}$		=	1.691/66.6		

Note: X_{CG} must be between 1.529 m and 1.780 m (19% and 37% MAC) as shown in Fig. 2.

6.2 Installed equipment list

This subsection contains a table with the list of the installed optional equipment affecting weight and balance of the aircraft. It is responsibility of the aircraft owner/operator that any such equipment installed in the aircraft after the date of its manufacture is listed in the table below.

No.	Equipment description and Part No.	Weight, kg	CG arm, m

No.	Equipment description and Part No.	Weight, kg	CG arm, m

7 Airplane and Systems Descriptions

7.1 General

This section provides description and operation of the airplane and its systems. Some equipment described herein is optional and may not be installed in the airplane. Refer to Section 9, Supplements, for details of other optional systems and equipment.

7.2 Airframe

Wing: high placed, strut braced, constant chord. Wing section is P-IIIa-15%. Wing primary structure consists of a single spar, ribs and aft web. Forward of the spar the wing has 2024T3 aluminum alloy skin of 0.020"-0.032" sheet, which together with the spar web forms the wing torsion box. Aft of the spar the wing is covered with the metal skin on top and thermoshrinkable fabric on the bottom side. Wing ribs are made of 6061T6 sheet of 0.020"-0.032" thickness. The spar is a riveted structure consisting of a web, made of 0.032" 6061T6 sheet, and caps, made of an extruded section (D16chT alloy angle). The wing strut attachment bracket and front attachment bracket of the wing are fixed to the spar. The rear attachment bracket of the wing is fixed to the aft web. The flaperon (drooping aileron) hinge brackets are fixed to ribs No. 1, 5, 9 and 13. All brackets are made of 5 mm 2024T3 sheet.

The primary structure of the flaperon consists of the leading edge skin, spar, trailing edge section and ribs. The LE skin and spar comprise the torsion box. Flaperon covering is made of synthetic thermoshrinkable fabric.

The fuselage is an all-metal semimonocoque structure. The frames are made of 6061T6 aluminum alloy sheets of 0.063" to 0.080" thickness. The fuselage skin is made of 2024T3 aluminum alloy sheets of 0.02" to 0.04" thickness.

Engine cowling is made of composites.

The doors, cockpit and part of the fuselage have windows of organic glass.

The primary structure of the all-flying horizontal tail (AFHT) of ribs and a spar. The leading edge skin is made of a 2024T3 aluminum alloy sheets of 0.020" thickness. Aft of the spar AFHT is covered with fabric. The AFHT has 2 hinge brackets of its attachment to fuselage.

The fin is made as integral part of the fuselage. It consists of a spar, ribs and 2024T3 aluminum alloy skin of 0.020" thickness.

7.3 Landing gear

Airplane landing gear is of tricycle type with steerable nose wheel. The main LG is of the cantilever spring type. The main LG leg is made of aluminum alloy. It is attached to the lower boom of the frame No. 3 at two points: upper and lower supports. The support brackets are machined of aluminum alloy. The main LG wheels are fitted with hydraulic disk brakes.

The nose LG leg is steerable, of trailing link type. The steering is ensured using the rudder pedals via pushrods, connecting the left and right side pedals with bellcrank on the strut. The leg consists of a strut and a trailing link in form of nose wheel fork. The trailing link is connected to the strut with a shock absorber/damper.

The nose leg is attached to the frame No. 1 at two points – at upper and lower supports. The upper support is made of 5 mm 2024T3 aluminum alloy sheet and the lower one is build-up. The supports are fitted with brass bearings.

Each wheel is fitted with a wheel spat (fairing) or mud screens (in case of the low-profile tires and 6.00×6 wheels).

Landing gear data: wheel base – 1.243 m (4 ft 1 in),
wheel track – 1.729 m (5 ft 8 in),
min. turn radius ~ 2 m (7 ft).

Main wheels: size – 6.00×6
pressure – 1.6 bar (22.7 psi)

Nose wheel: size – 6.00×6 brakeless wheel
steering angle ±30 degrees
pressure – 1 bar (14.5 psi)

7.4 Engine and its controls

This aircraft is equipped with a four-cylinder four-stroke Rotax-912ULS (100 hp) carburetor combined cooling engine produced by BRP-Rotax GmbH&Co KG, Austria.

The engine is has the flat-four layout, dry sump lubrication system with a separate oil tank of 3 l (0.8 US gal) capacity, automatic valve clearance adjustment, two carburetors, mechanical membrane fuel pump, double electronic ignition system, integrated water pump, electrical starter, integrated gearbox of 2.43 reduction ratio.

All engine systems (fuel, electrical, cooling) are assembled in accordance with Rotax-912 engine operation manual.

The engine can be optionally fitted with an air intake pre-heater box designed by Aeroprakt, which improves engine operating conditions, preventing carburetor icing in cold weather and increasing the engine output in hot weather.

7.5 Propeller

A-32 airplane may be fitted with any propeller, approved by Aeroprakt Ltd.

7.6 Fuel system

The fuel system (see **Fig. 3**) includes two wing fuel tanks (1,2), fuel lines (5,6,9,10,12,14,16,18,19,20,), two shut-off valves (7,8), fuel sediment collector (11), fuel filter (13), fuel pump (17), return line (24), drain line (25) and drain valve (25). The fuel tanks (11.9 (15.05) US gal each) are located at the wing root between the spar and aft web. The fuel inlet 3(4) is located at the front outboard corner of the tank. The inlet cover has vent fitting 27(28) connecting the tank volume free of fuel to the atmosphere. The fuel shut-off valves (7,8) are located on the vertical beams of the frame No.3, on the left and right sides respectively. The shut-off valve is open when its handle is set vertically and closed when the handle is set horizontally. The left and right fuel tank is connected with the fuel lines to the left and right fuel shut-off valve respectively. Further two fuel lines are joined into a single one with the fuel sediment collector (11). The fuel sediment collector is located near the web of the frame No.4 at its bottom part. The top outlet of the fuel sediment collector is connected to the fuel filter (13) located on the right side behind the main landing gear beam. The fuel filter can be inspected visually through a window in the protecting cover of the aileron control cables. The bottom outlet of the fuel sediment collector is connected with a fuel line (25) to the drain valve (26), located between the frame No.4 and the main landing gear beam. The drain valve allows draining fuel through the hole in the bottom rear panel of fuselage. The drain valve itself is located under the protecting cover separating it from the cables of the longitudinal and directional flight controls. The valve handle is accessible outside of the fuselage. After the fuel filter the fuel line (14) runs through the main landing gear beam, seat beam along the right-hand side of fuselage to the firewall where it is connected with a 90° bulkhead fitting (15), that is passing through the hole in the firewall, to the fuel line of the engine (16) and is connected to the inlet of the fuel pump (17) located on the right-hand side of the engine gearbox. The pump outlet is connected with the fuel lines (18,19,20) to the carburetors (21, 22). The excessive fuel is returned through the line (24) to the sediment collector (11). The fuel system optionally may contain also fuel pressure sensor (23).

	Standard	Optional
Capacity of tanks:	2×45 l (11.9 US gal)	2×57 l (2×15.05 US gal)
Total fuel capacity:	90 l (23.8 US gal)	114 l (30.1 US gal)
Total usable fuel:	89.5 l (23.6 US gal)	113.5 l (30.0 US gal)
Non-usable fuel:	0.5 l (0.1 US gal)	0.5 l (0.1 US gal)

NOTE: When both tanks are full, fuel may flow from one tank to the other (e.g. due to the lateral forces during side slipping or when wings are not level on parking or during taxiing), overfill it and spill out through the vent line. To prevent this close one of the fuel valves.

CAUTION! At all times during the flight ensure fuel coming to the engine by opening the valve(s) of the tank(s) WITH fuel. If one of the tanks is empty, close its valve to prevent air getting into the fuel line and causing engine malfunction or even failure.

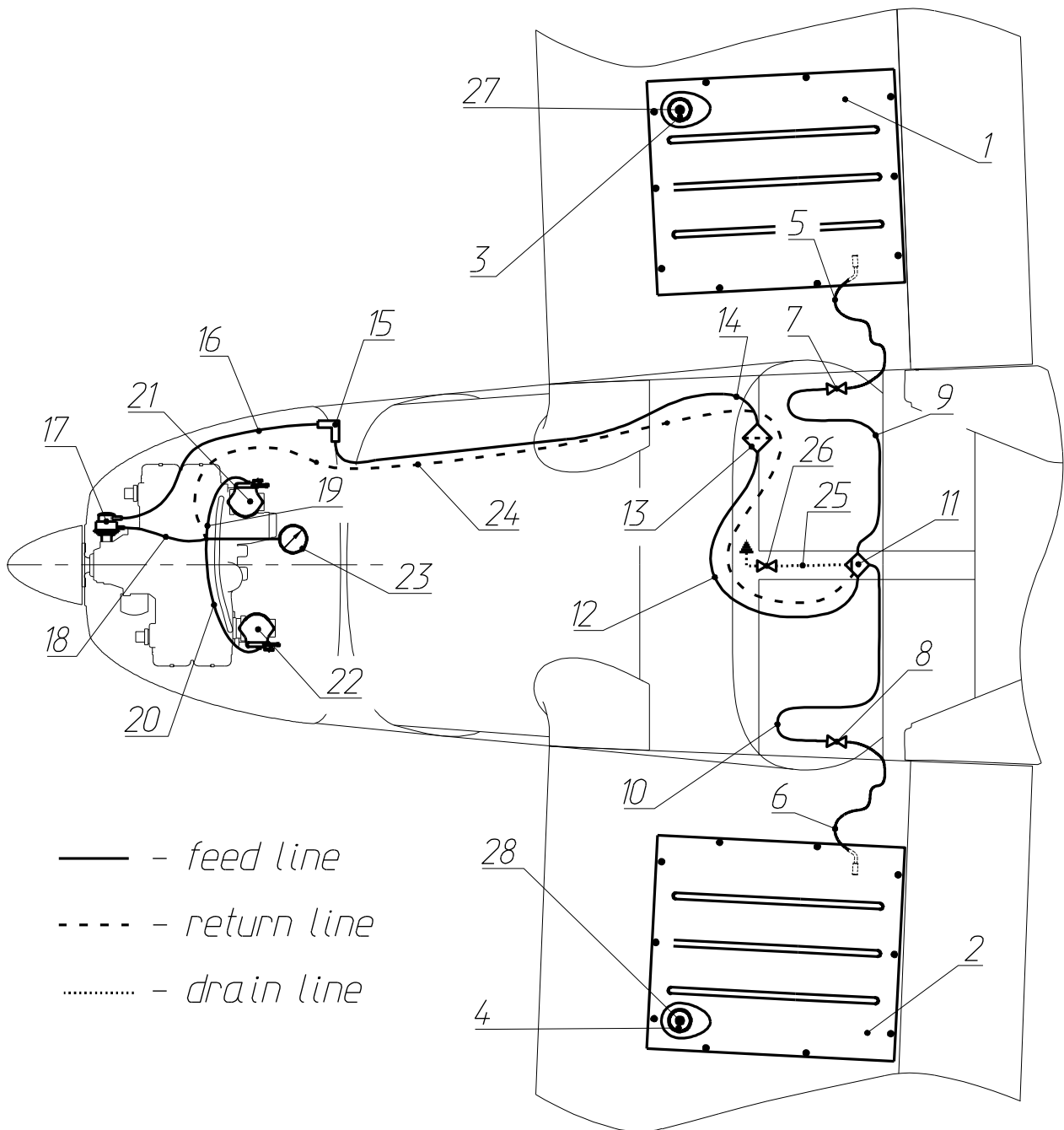

Fig. 3. Fuel system schematic

7.7 Airplane control systems

Airplane control systems include control systems for drooping ailerons (flaperons), elevator with trim tab, rudder and nose wheel, engine and brakes.

The control system is combined consisting of foot- and hand-actuated subsystems.

Ailerons and elevator are hand-actuated and are controlled using yokes. The rudder and nose wheel control is foot-actuated using pedals.

7.7.1 AFHT control system

The all-flying horizontal tail (AFHT) control system (see **Fig. 4**) is combined, it consists of two 4.0 mm (5/32") cables, passing through a block of pulleys and a fairlead, bellcrank and pushrod.

“Push” and “pull” forces are applied by the pilot to the yoke (1) is passed via the control column (2) to the cables (3). Then via the bellcrank (4) located near the frame No.9, the control forces is passed to the pushrod (5) connected to the AFHT arm (6). The cables routing is ensured with a block of pulleys (7), located in front of the seat beam and fairlead (8) on the luggage container wall. The cable tension and AFHT incidence angle adjustment is ensured using the turnbuckles (9) located forward of the bellcrank (4).

AFHT deflection angles: $15\pm 1^\circ$ up and $5\pm 1^\circ$ down.

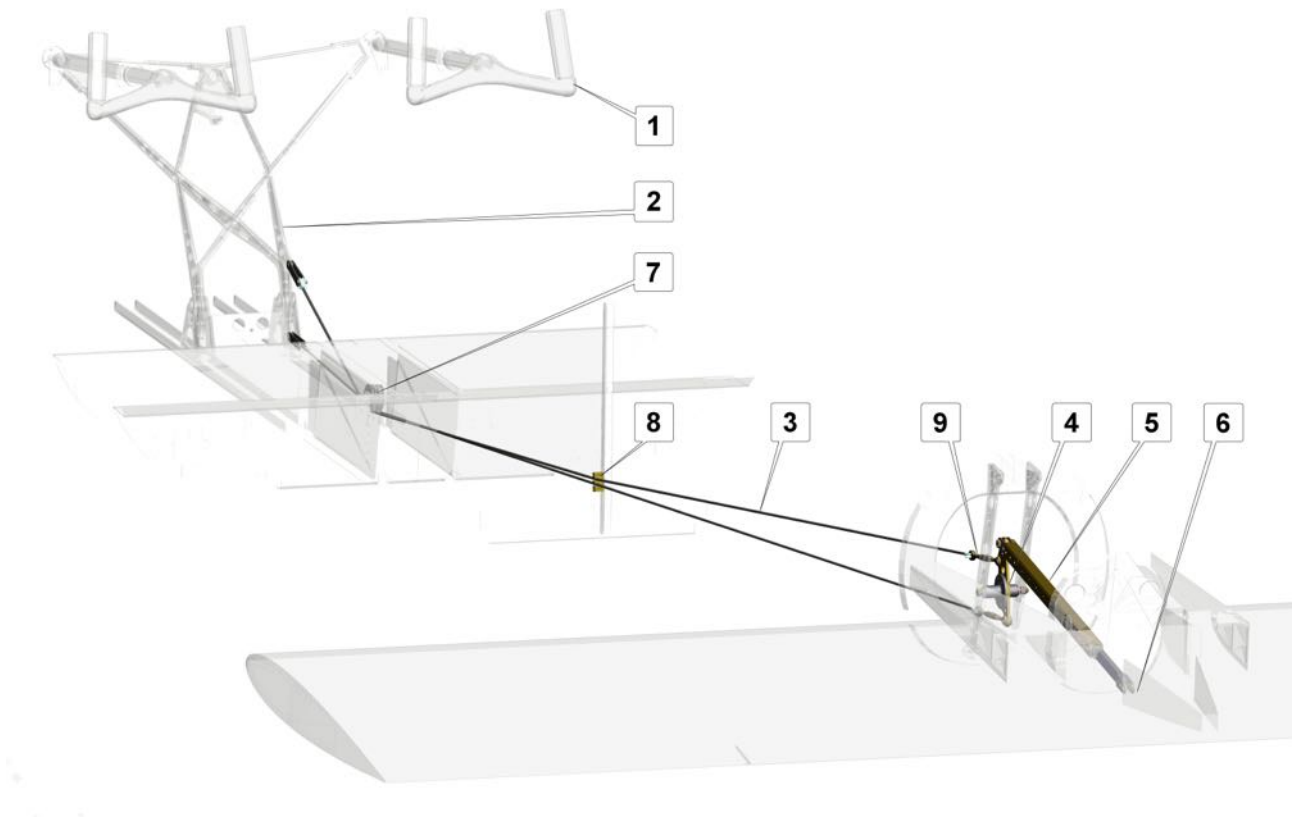

Fig. 4. AFHT control system

7.7.2 AFHT antiservo/trim tab control system

The AFHT antiservo/trim tab is used for controlling the force on control yokes in pitch.

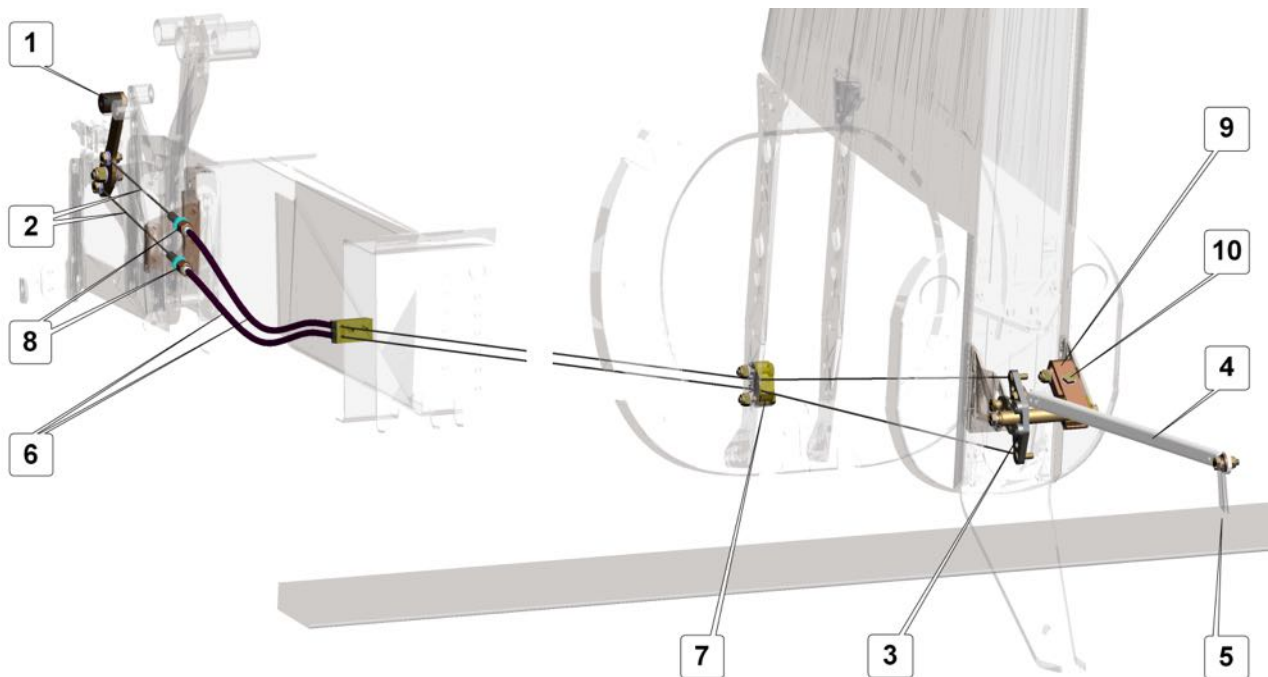

Fig. 5. AFHT antiservo/trim tab control system

The AFHT antiservo/trim tab control system (**Fig. 5**) is combined, it consists of a lever (1), two Ø1.5 mm (1/16 in) cables (2), a bellcrank (3), a friction clamp (9) and a rod (4).

The trim control lever (1) is located on the central console forward of the pilot seats and is accessible for both pilots. The trim tab control lever is connected with cables (2) to the trim tab control bellcrank (3). The cables are running through the flexible sheaths (6) in the central console and a fairlead (7) located near frame No.9. The antiservo/trim tab is hinged at the trailing edge of the AFHT.

Tension of the cables and antiservo/trim tab alignment can be ensured using the adjustable forward stops of the sheaths (8), located aft of the seat beam. The trim control lever friction force can be adjusted using the bolt (10) of the friction clamp (9), located on the bellcrank axle (3).

The antiservo/trim tab angles of deflection are: upward $7.4 \pm 1^\circ$, downward $7.6 \pm 1^\circ$.

7.7.3 Rudder and nose wheel control system

The rudder and nose wheel control system (**Fig. 6**) is combined, it consists of pedals, nose landing gear strut control bellcrank, two pushrods, two Ø2.5 mm (3/32 in) cables, passing through two front and two rear pulleys.

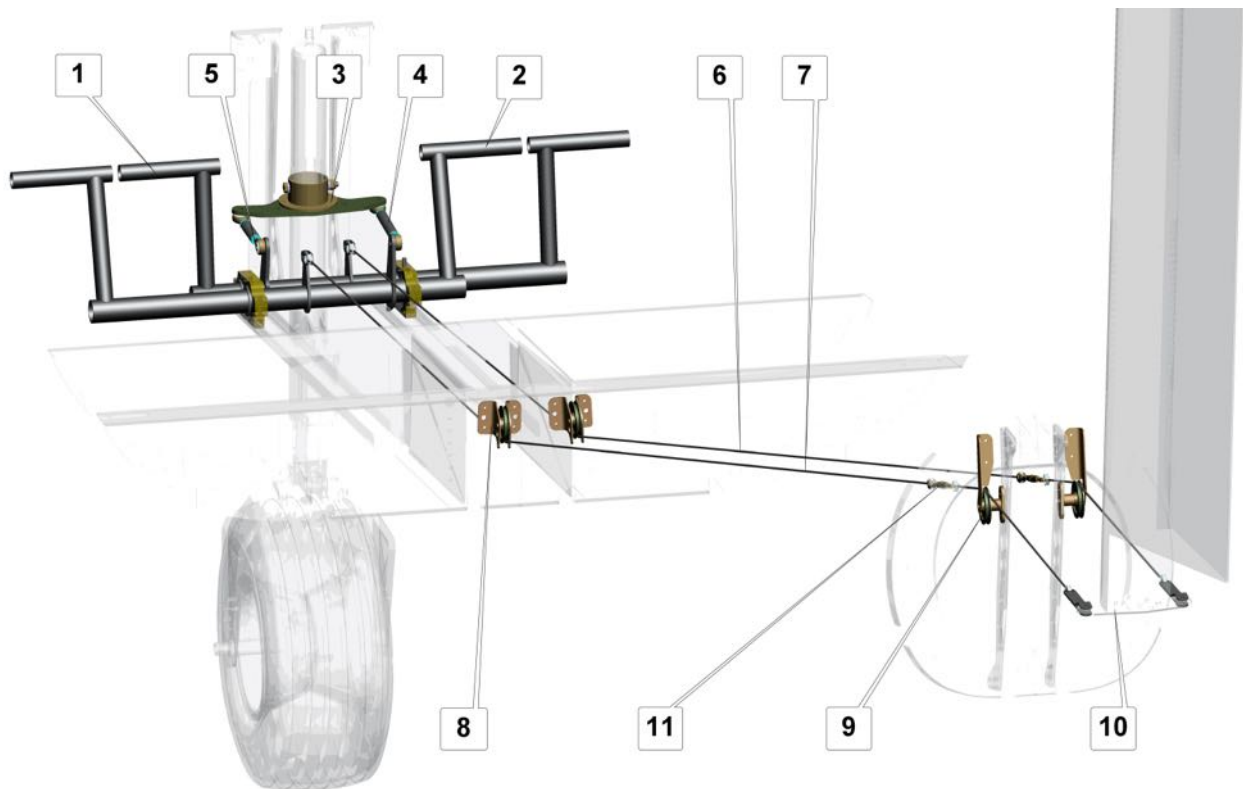

Fig. 6. Rudder and nose landing gear control system

The front (right) pedals (1) and rear (left) pedals (2) are fixed with nylon supports to longitudinal beams of the cockpit floor. The bellcrank (3) attached to the nose landing gear strut is connected to the pedals with the right (4) and left (5) pushrods. The right (6) and left (7) cables connect the pedals to the rudder arms. The cable routing is ensured with two pulleys (8) on the frame No.3 and two pulleys (9) near the frame No.9.

Adjustment of the nose landing gear position is achieved with pedals set to neutral position using pushrods (4) and (5). The cable tension and adjustment of the rudder position is achieved using the turnbuckles (11) located near the frame No.9.

In its neutral position the rudder is deflected to the right by the angle of $+2.5^\circ$ (to the right) for compensation of the engine torque. The rudder deflection angle to each side is $25 \pm 1^\circ$.

7.7.4 Control system of flaperons (drooping ailerons)

The airplane is equipped with flaperons (drooping ailerons), which serve as both ailerons and flaps. The flaperon control system ensures independent function of flaperons as ailerons and flaps by means of aileron drooping (flap extension) mechanism. The flaperon control system (**Fig. 7**) is combined and, beside the aileron drooping mechanism, it includes two yokes, control column, two control column pushrods, control column bellcrank, two Ø2.5 mm (3/32 in) cables, passing through a system of pulleys, two inner and two outer bellcranks, two inner and two outer pushrods.

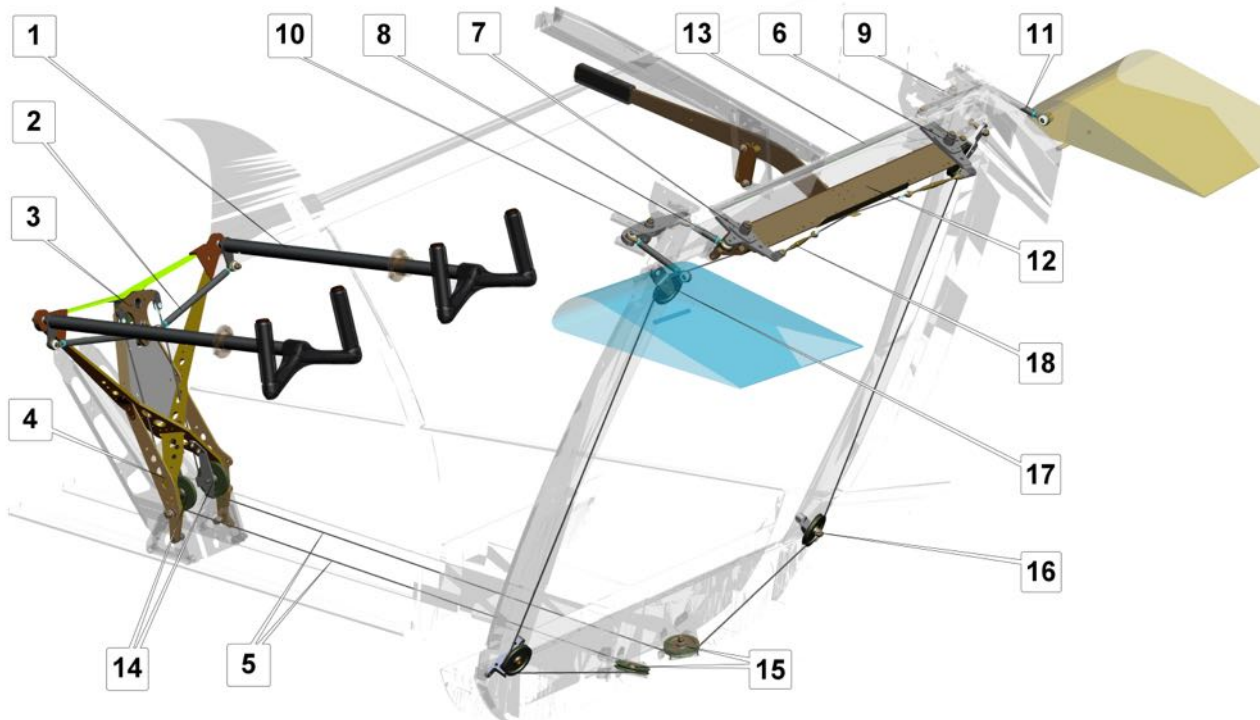

Fig. 7. Control system of flaperons (drooping ailerons)

The control force in roll applied by the pilot to the yoke 1 is passed via the pushrods (2) to the bellcrank (3) located on the control column (4). Then via the cables (5) the force is passed to the inner right (6) and left (7) bellcranks, via the inner pushrods (8) to the outer right (9) and left (10) bellcranks. Then the control force is passed from the outer bellcranks to the flaperons via the outer pushrods (11). The inner bellcranks hinged on the flap extension mechanism beam (12) are connected to each other with the pushrod (13). The cables are routed using two pulleys (14) on the control column, two pulleys (15) aft of the frame No.3 low in the middle, two pulleys (16) aft of the frame No.3 low on the sides, and two pulleys (17) on the frame No.3 up near the rear wing attachment points.

The cable tension and flaperon position adjustment is achieved using the turnbuckles (18) located near the inner bellcranks (7).

Deflection angles of the flaperons (as ailerons): up – $20 \pm 1^\circ$, down – $13 \pm 1^\circ$.

The aileron drooping (flap extension) mechanism (**Fig. 8**) consists of a beam with lever (1) hinged to the upper rim of the frame No.3. Flap position setting is achieved with the fixer (2) having three holes for the pin (3) on the lever. Unfixing is achieved by bending the spring-like lever to the right. After the pin comes out of the fixer hole the lever can be set to the selected position. When the pin aligns with another hole of the fixer the lever springs back fixing the flaperons in a different position.

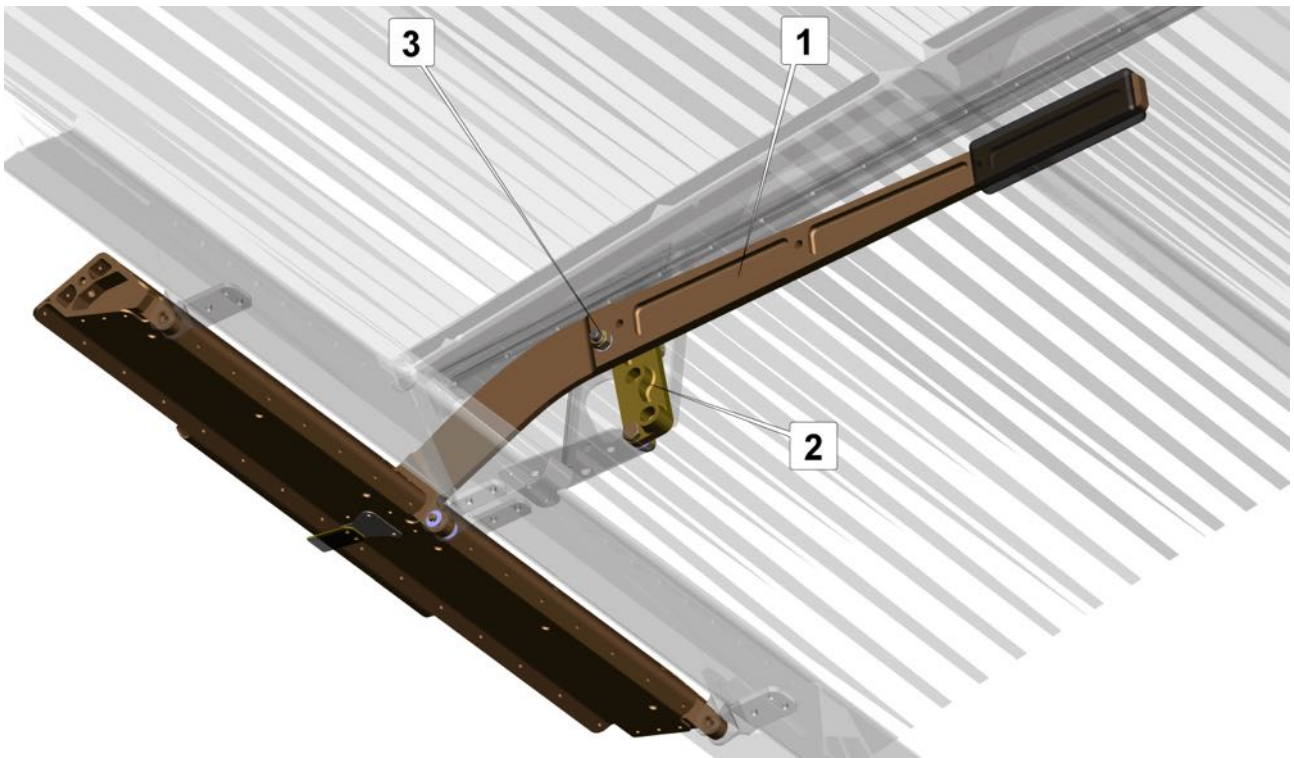

Fig. 8. Flap extension mechanism

Aileron drooping (flap extension) angles: 1st position – $10 \pm 1^\circ$, 2nd position – $20 \pm 1^\circ$.

7.7.5 Engine controls

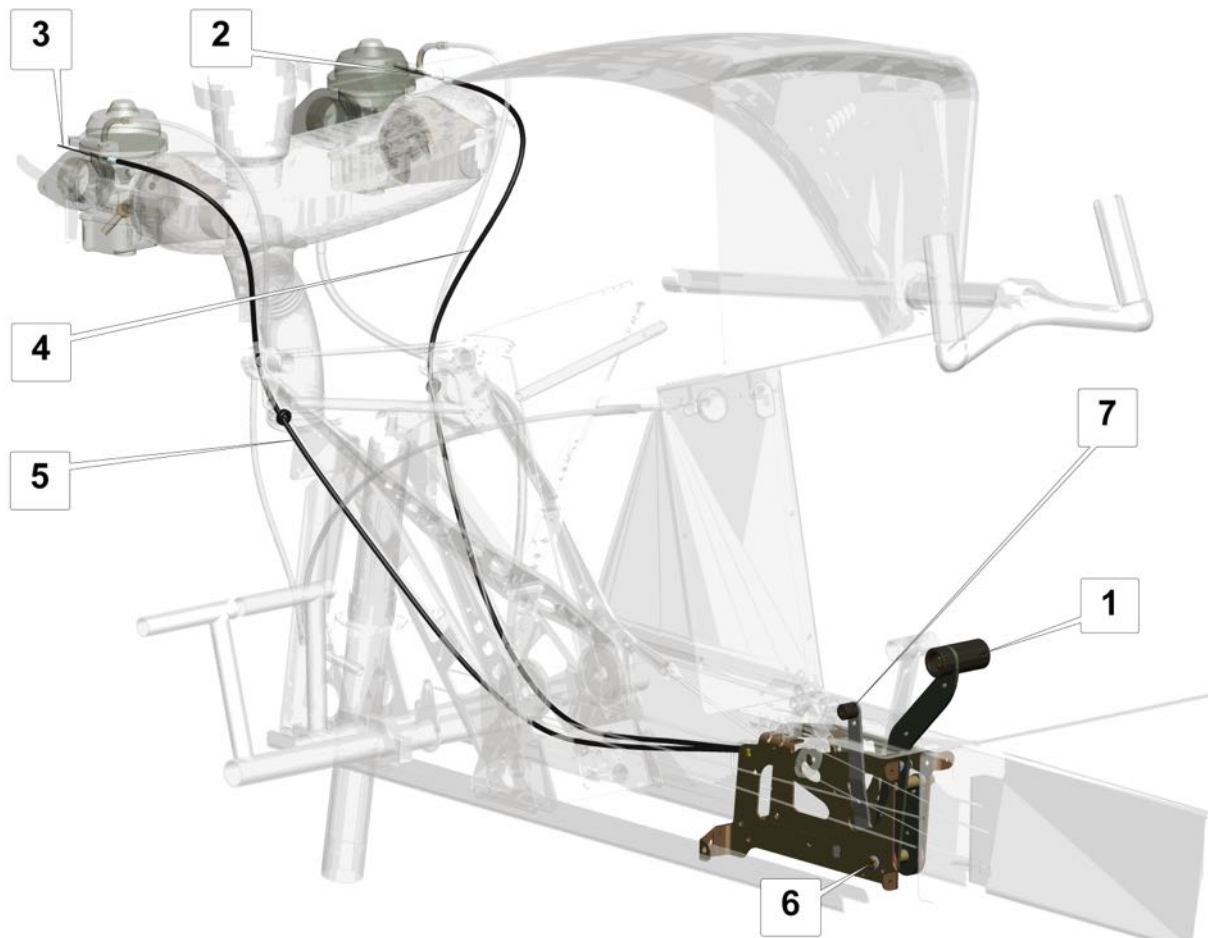

Fig. 9. Engine RPM controls

The engine control system includes engine RPM (throttle) controls, engine starting fuel mixture (choke) controls, carburetor heating controls (with air intake box installed). The engine controls are located on the central console and are accessible from both right and left side pilot seat.

The engine RPM control (**Fig. 9**) is achieved using the throttle lever (1) connected with the cables to the throttle control arms of the right (2) and left (3) carburetor. The cables are passed through the flexible sheaths – the right (4) and the left (5) one. The throttle lever friction force can be adjusted on the ground by tightening the bolt (6) or in flight – using the friction force adjusting lever (7).

Rearmost throttle lever position corresponds to MIN engine RPM, the foremost position – to MAX engine RPM. Pulling the friction force adjusting lever back increases the throttle lever friction, pushing it forward – reduces.

Engine pre-start mixture control (**Fig. 10**) is achieved using the choke control lever (1), connected with cables to the choke control arms of the right (3) and left (4) carburetor. The cables are passed through the flexible sheaths – the right (5) and the left (6) one.

Rearmost choke lever position corresponds to OFF, the foremost position – to ON.

Carburetor heating control (**Fig. 1**) is achieved by means of controlling the position of the shutter (2) in the air intake box (1) covering the air filters of the carburetors. The control lever (3) is connected to the shutter with forward (4) and rear (5) push-pull cables and clip (6). The cables are enclosed in forward sheath (7, fixed to air intake box) and rear sheath (8, fixed to the instrument panel) connected to each other with a clamp (9).

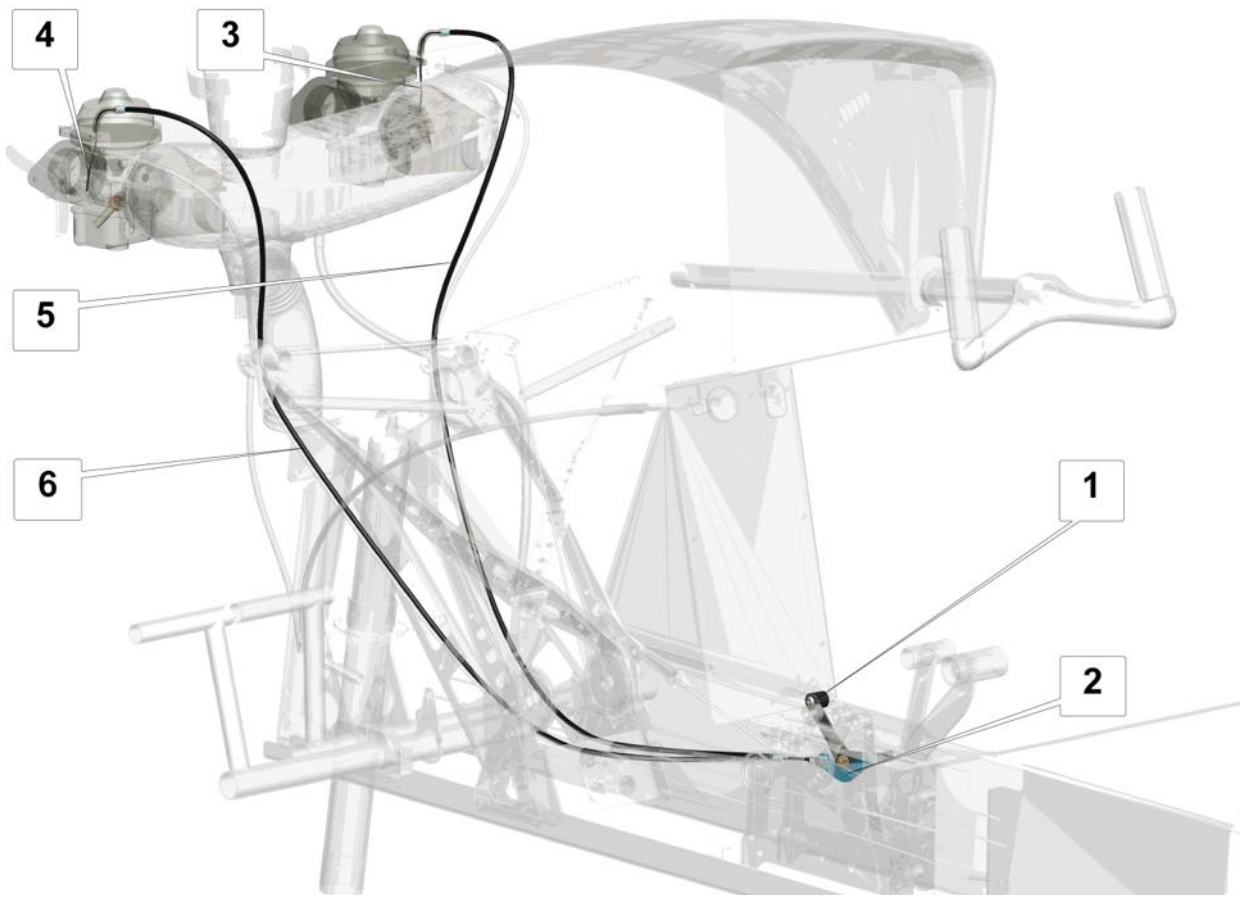

Fig. 10. Engine pre-start mixture control

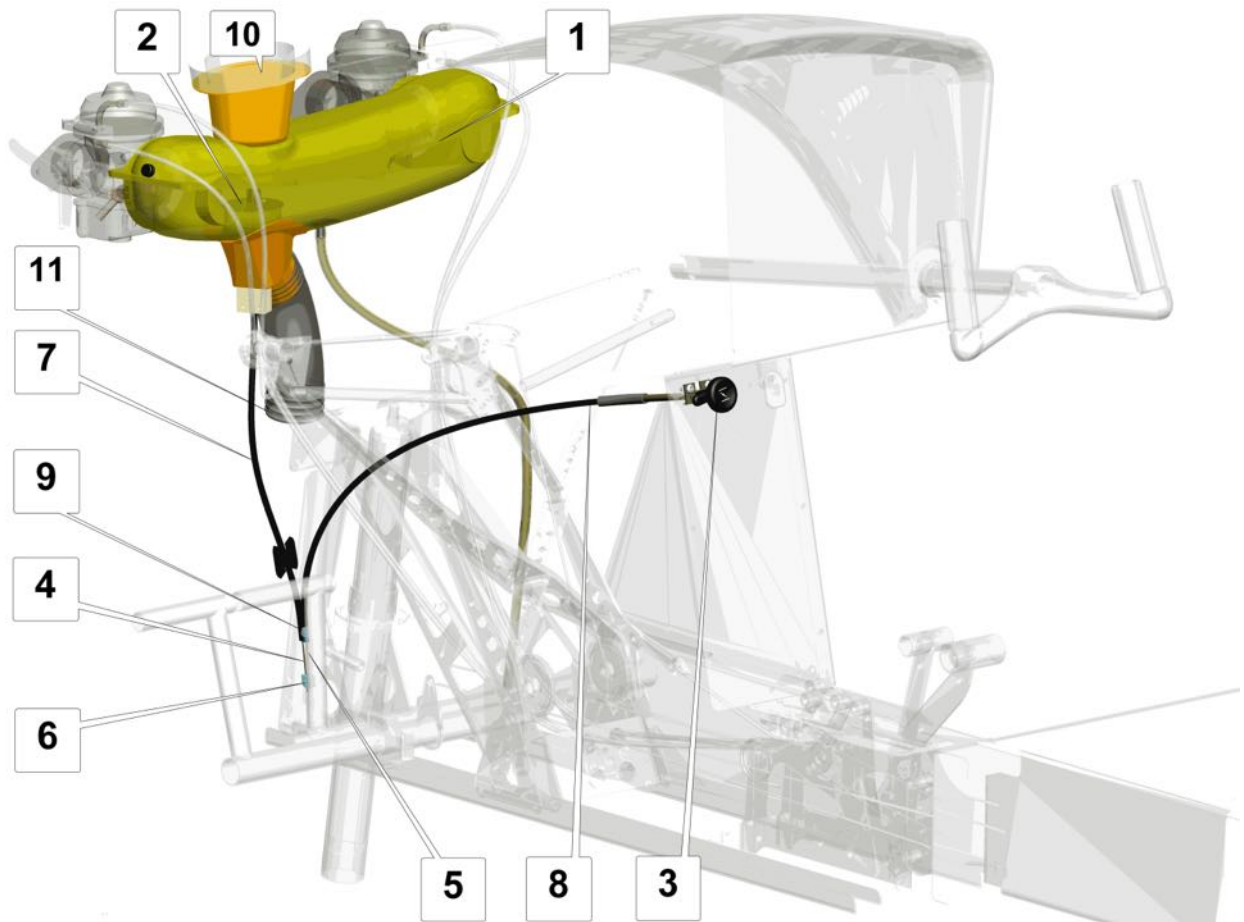

Fig. 1 Carburettor heating control

To set the carburettor heating to OFF – PUSH the control knob (3) forward – the shutter is set to its lower (open) position and ambient cold air comes through the air intake on top of the engine cowling. To set the carburettor heating to ON – PULL the control knob back, the shutter is set to its upper (closed) position and warm air comes through the duct (1) from the exhaust muffler.

7.7.6 Brake control system

The main wheel brakes (**Fig. 11**) are actuated hydraulically using the brake lever (2) (installed next to the throttle lever 3) controlling the pressure supplied from the master cylinder (1) to the slave cylinders (5) in the wheels.

The main LG wheels have disk brakes. The cylinders are connected to each other with copper tubing 6 with outside diameter of 3 mm. The master cylinder (1) is connected with a hose (8) to the extension tank (7), installed on the firewall in the engine compartment.

When the brake lever is pulled the brake pads squeeze the brake disc creating the braking moment proportional to the applied force.

A-32 is equipped also with a parking brake, which is actuated with a lever (4) on the central console. To use the parking brake, set the lever to 'Parking brake ON', then pull and release the brake lever. The brake pads will remain pressed to the brake disc. To release the parking brake set its control lever to its initial position ('Parking brake OFF').

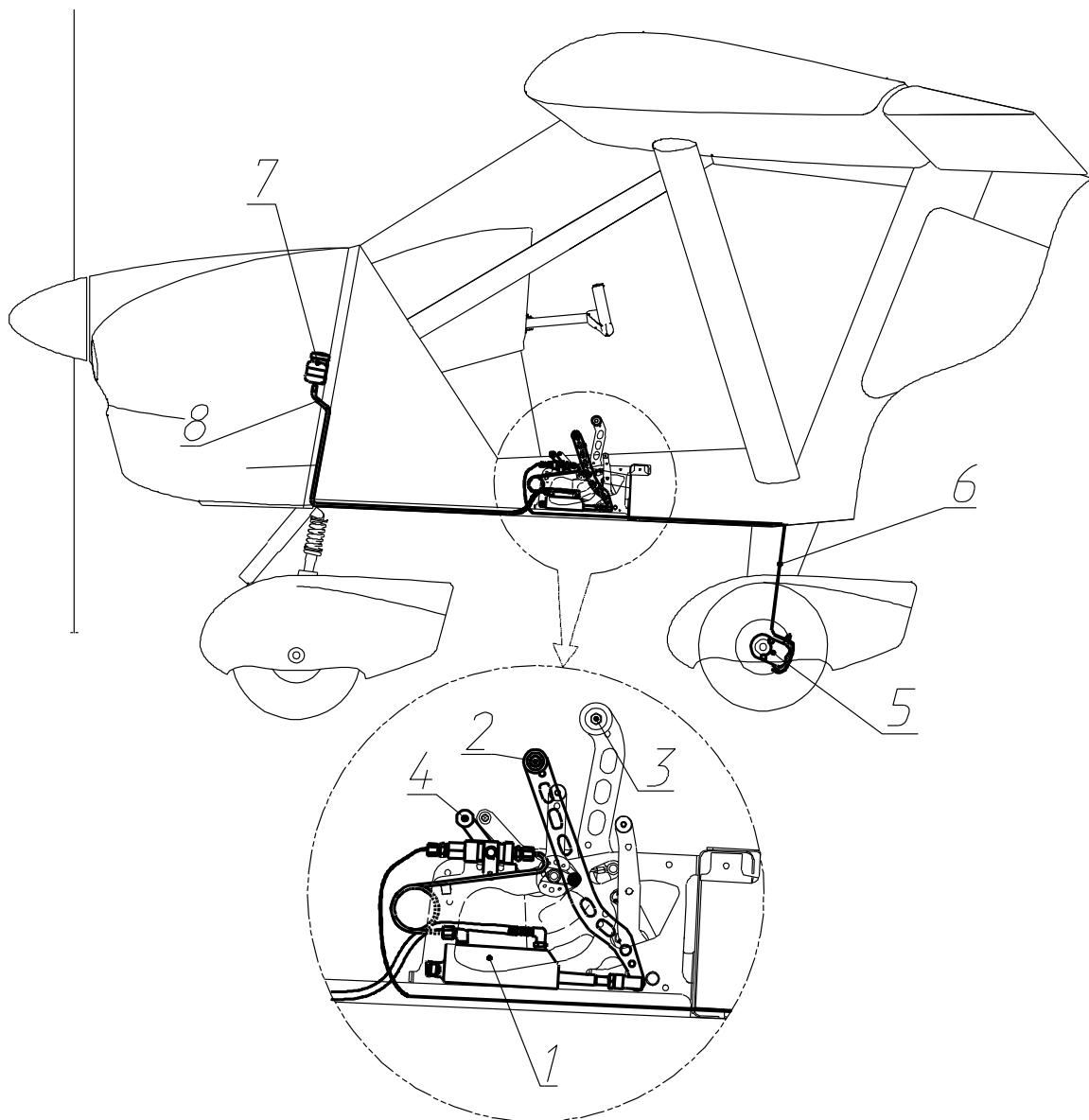

Fig. 11. Brake control system

7.8 Instrument panel

This airplane has the following flight instruments set and instrument panel arrangement:

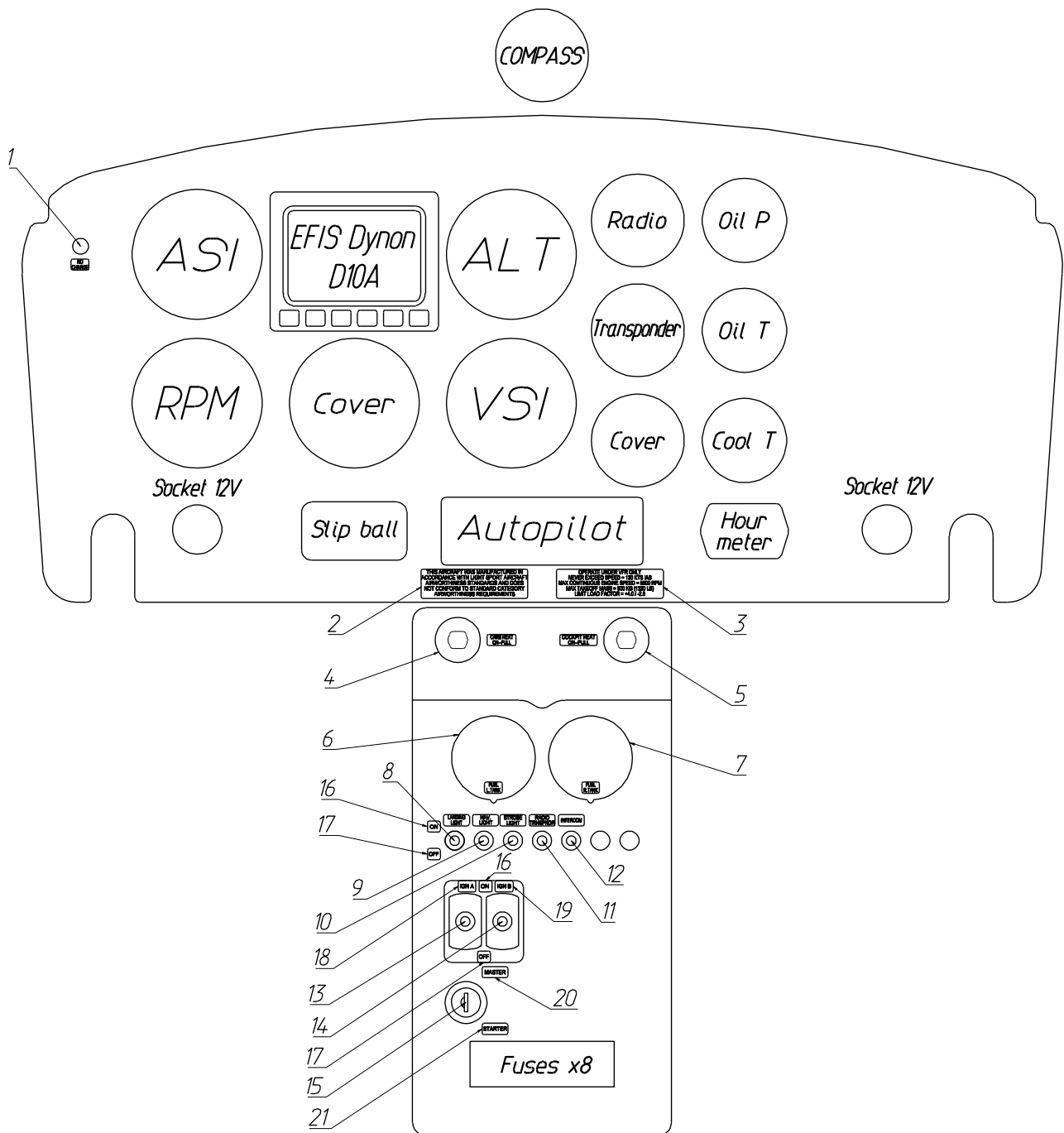

Fig. 12. Instrument panel

Numbers in **Fig. 12** denote the following:

1. NO CHARGE indicator and marking
2. Placard with passenger warning:

THIS AIRCRAFT WAS MANUFACTURED IN
ACCORDANCE WITH LIGHT SPORT AIRCRAFT
AIRWORTHINESS STANDARDS AND DOES NOT
CONFORM TO STANDARD CATEGORY
AIRWORTHINESS REQUIREMENTS"
3. Placard with operating limitations:

OPERATE UNDER VFR ONLY
NEVER EXCEED SPEED = 130 KTS IAS
MAX CONTINUOUS ENGINE SPEED = 5500 RPM
MAX TAKEOFF MASS = 600 KG (1320 LB)
LIMIT LOAD FACTOR = +4.0 / -2.0
4. Carburetor heating control knob and marking
5. Cockpit heating control knob and marking
6. Left tank fuel level indicator and marking
7. Right tank fuel level indicator and marking
8. Landing light switch and marking
9. Navigation lights switch and marking
10. Strobe lights switch and marking
11. Radio, transponder switch and marking
12. Intercom switch and marking
13. IGN A switch
14. IGN B switch
15. Master and starter key
16. ON marking for electric and ignition switches
17. OFF marking for electric and ignition switches
18. IGN A marking
19. IGN B marking
20. MASTER marking
21. STARTER marking

7.9 Full and static pressure system

This system supplies the full (dynamic) and static pressure of the outside air to the instruments measuring the flight parameters: airspeed, rate of climb and altitude. The system consists of the full and static pressure probe (1) and full (2) and static (3) pressure lines connecting the probe to the instruments (see **Fig. 13**). Full and static pressure lines have joints (4) used to disconnect the lines when the left wing is removed during aircraft disassembly.

The full and static pressure lines are connected to the airspeed indicator(s). Static pressure for altimeter and vertical speed indicator is supplied from the cockpit.

Good condition of the full and static pressure system is important for correct measurement of the flight parameters and therefore for flight safety. Pilots must take measures to keep the system in good condition: protect the full and static pressure probe with a cover (marked with a red "Remove before flight" flag) and inspect the probe and lines during the preflight check to make sure that they are not damaged or blocked (by water, ice, dirt, etc.). The probe must be covered again after the flight.

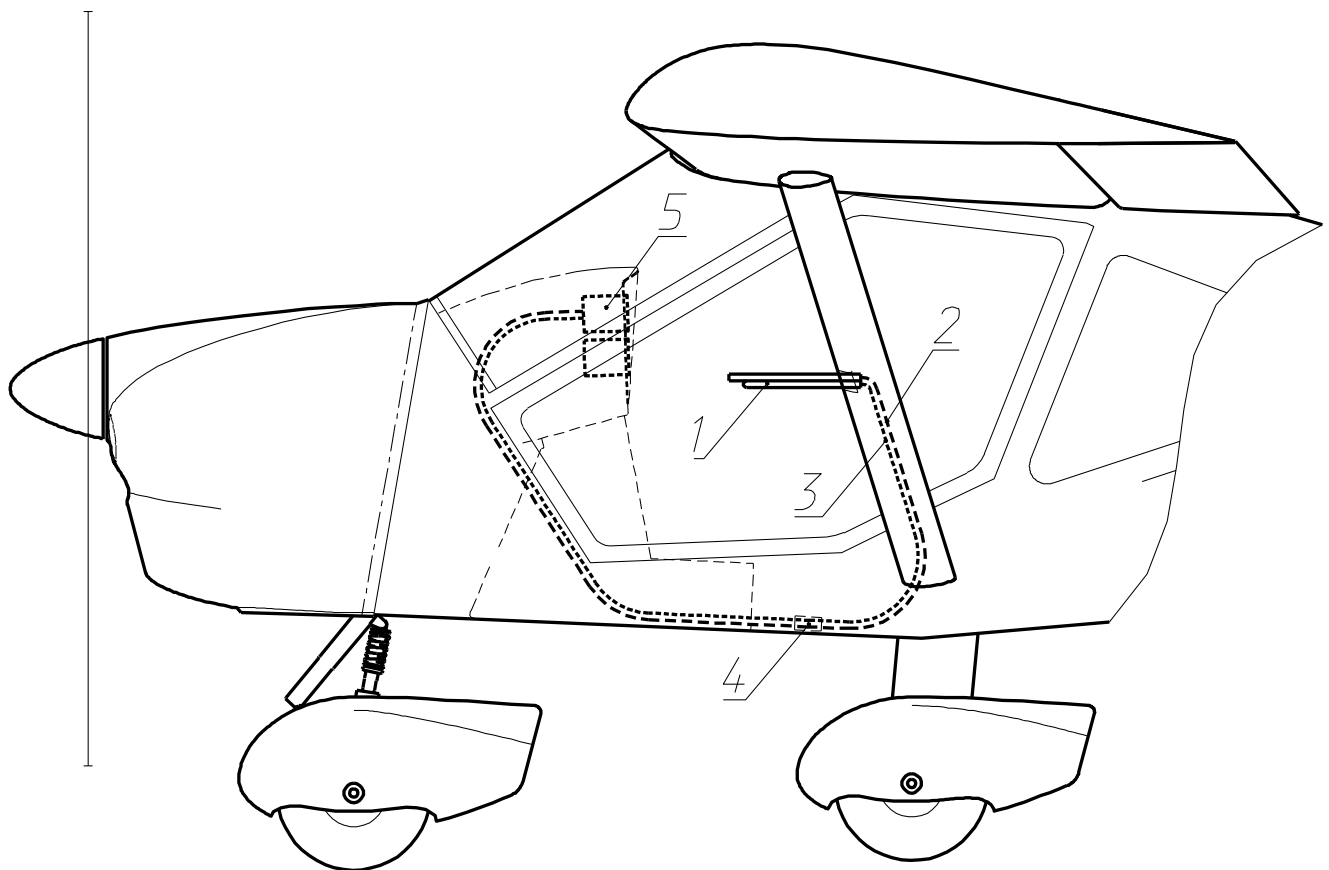

Fig. 13. Full and static pressure system

7.10 Electrical system

Electrical system of A-32 serves for generation of electrical power and supplying it to the onboard electrical consumers.

When engine is running (at RPM above 1400), electrical power is generated by the engine alternator, converted by a rectifier-regulator (located on the firewall) and is supplied to the consumers and stored in a 12V DC 19Ah battery, located behind the left pilot seat. The consumers (engine starter, instruments, lights, etc.) are supplied with the electrical power through the electrical cables of appropriate section (depending on the consumed current), switches and fuses (located on the instrument panel). The fuses are required to protect the electrical system and consumers from short circuit and must be of appropriate type and size.

When battery is supplying power to the consumers while alternator is not generating and supplying power to the battery (e.g. engine is not running or due to some other reason) NO CHARGE light signals that the battery is discharging and its power may be lost after some time. When alternator starts recharging the battery NO CHARGE light goes out.

MASTER switch controls power supplies of all onboard consumers (except for the engine ignition system and consumers with their own built-in power source, e.g. GPS) together with the electrical switches for separate consumers. The engine ignition system may be switched ON/OFF only with the ignition switches.

Electrical system wiring depends on the electrical equipment/instruments installed in the aircraft and therefore has main and additional (optional) portions. The respective wiring diagrams are shown on **Fig. 14** to **Fig. 19**.